

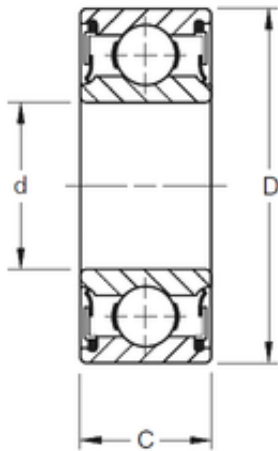

BEARING de Mexico?S.A.

50 mm x 110 mm x 44,45 mm Timken W310PP
Rigid ball bearings



Bearing No. W310PP

Size	50x110x44.45 mm
Bore Diameter	50 mm
Outer Diameter	110 mm
Width	44,45 mm
d	50 mm
D	110 mm
B	44,45 mm
C	44,45 mm
Weight	1,828 Kg
Basic dynamic load rating (C)	69 kN

W310PP Bearing 2D drawings and 3D CAD models