

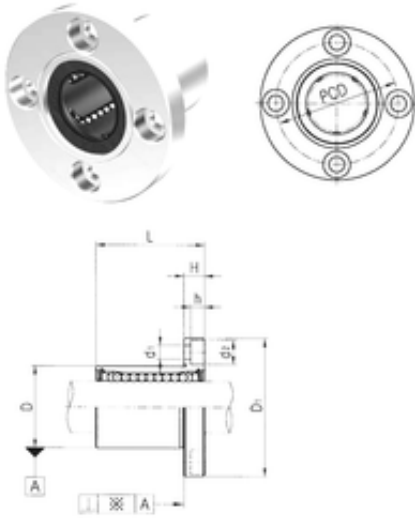

BEARING de Mexico?S.A.



LMEF30UU Bearing 2D drawings and 3D CAD models

Samick LMEF30UU Linear bearings

Bearing No. LMEF30UU

Bore Diameter	30 mm
Outer Diameter	47 mm
d	30 mm
D	47 mm
d1	6,6 mm
d2	11 mm
h	6,5 mm
D1	76 mm
H	10 mm
L	68 mm
PCD	62 mm
Tolerance perpendicularity (C)	15
Weight	0,545 Kg
Basic dynamic load rating (C)	1,56 kN